

CENTER TOWNSHIP SECTION 19 R10- TWP 6 MORGAN COUNTY, OH

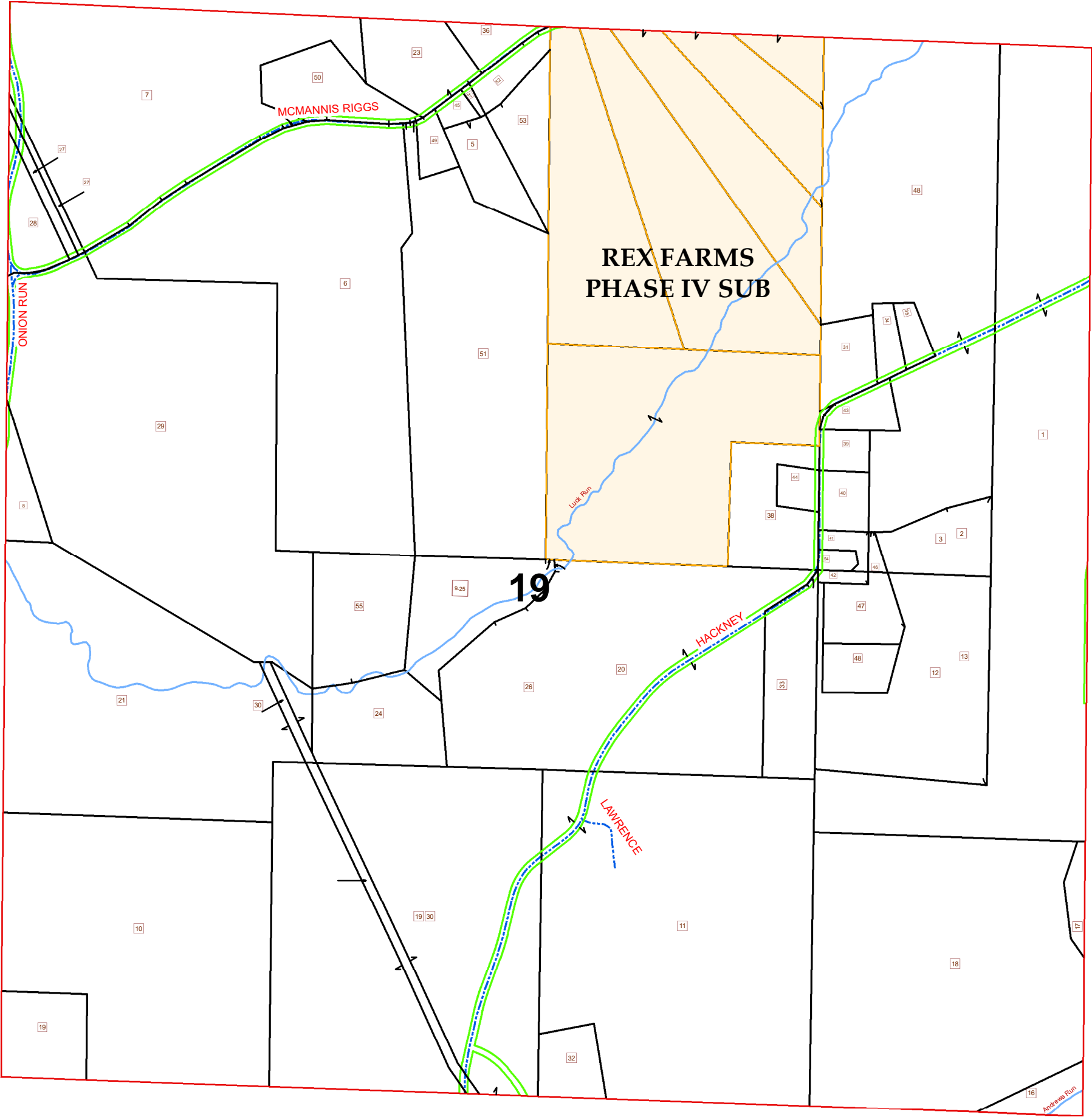

PIN	VOL	PAGE	Owner	LegalDescr	Acres
030-000-110-0	OR18	651	ALLEN HARRY D & SANDRA K	R10 T06 S19 SD 42 SURV/VRSHIP	0.35
030-008-280-1	OR18	651	ALLEN HARRY D & SANDRA K	R10 T06 S19 SD 46 SURV/VRSHIP	0.296
030-000-100-0	OR18	651	ALLEN HARRY D & SANDRA K	R10 T06 S19 SD 41 SURV/VRSHIP	0.687
030-000-120-0	OR206	616	ALLEN JEFFREY W	R11 T06 S19 SD 39	1.14
030-008-291-1	OR194	81	BROWNRIGG JONATHON L	R10 T06 S19 SD 48	2
030-003-060-0	OR219	1201	CARDER BEAU A & ASHLEY D LOCKH	R10 T06 S19 SD 43 SURV/VRSHIP	1.53
030-003-530-0	OR148	5	CLARK MARVIN E & DEANA J	R10 T06 S19 SD 34 SURV/VRSHIP	1
030-007-220-1	OR43	511	CLARK SAMUEL C & LYNDA L	R10 T06 S19 SD 44 EX ALL MINERALS SUR	1.004
030-007-220-0	OR43	511	CLARK SAMUEL C & LYNDA L	R10 T06 S19 SD 38 SURV/VRSHIP	5.296
030-004-020-0	OR49	470	DAVIS MARK R & DEBORAH D	R10 T06 S19 SD 20-26 SURV/VRSHIP	34.08
030-006-670-4	OR163	516	DUSKEY BRIAN S & AMANDA J	R10 T06 S19 SD 51 SURV/VRSHIP	28.719
030-003-560-0	OR233	4242	DUSKEY BRIAN SCOTT & AMANDA J	R10 T06 S19 SD 9-25 STEVEN 1/2 INT STEV	6.52
030-006-680-0	OR222	3188	DUSKEY DOUGLAS E	R10 T06 S19 SD 06	41.829
030-006-360-0	OR231	5698	DUSKEY DOUGLAS E & DRAKE KYLIE	R10 T06 S19 SD 29 F WATSON	50
030-003-560-1	OR233	4239	DUSKEY DOUGLAS E & KYLIE D DRAK	R10 T6 S19 SD55	6.982
030-002-530-0	OR231	112	DUSKEY RUSSELL L ET4AL	R10 T06 S19 SD 16	1.461
030-003-890-0	OR224	2252	ERB ELIZABETH A AKA ELIZABETH ER	R10 T06 S19 SD 31	2.431
030-003-600-0	D.V 186	263	FERGUSON DAVID G & MICHELE	R10 T06 S19 SD 40	1.72
030-007-380-0	OR233	5942	FLESHER FAMILY TRUST & WILLIAM H	R10 T06 S19 SD 17 SURV/VRSHIP	1.03
030-003-580-0	D.V 161	455	LAWRENCE DONALD E JR & LINDA L	R10 T06 S19 SD 11	47.61
030-003-860-0	OR210	2477	MCCURDY JAPHETH D	R10 T06 S19 SD 33	5.5
030-000-100-1	OR204	291	MORGENSTERN JARED W & SHELLEY	R10 T06 S19 SD 54 SURV/VRSHIP	0.463
030-006-440-0	OR219	3123	OHIO FRANKLIN REALTY LLC	R10 T06 S19 SD 32 HUGH GRAHAM	2.39
030-005-950-0	D.V 48	528	OHIO FRANKLIN REALTY LLC	R10 T06 S19 SD 19 M WATSON	4.25
030-005-980-0	OR219	3123	OHIO FRANKLIN REALTY LLC	R10 T06 S19 SD 18 DIEST & KINCAID	38.97
030-005-960-0	OR219	3123	OHIO FRANKLIN REALTY LLC	R10 T06 S19 SD 10 M WATSON	33.49
030-006-000-0	OR219	3123	OHIO FRANKLIN REALTY LLC	R10 T06 S00 S 19-30	57.19
030-005-970-0	OR219	3123	OHIO FRANKLIN REALTY LLC	R10 T06 S19 SD 24 M WATSON	6.85
030-006-500-0	OR230	3269	OHIO FRANKLIN REALTY LLC	R10 T06 S19 SD 28 E MCMANNIS	2.14
030-006-480-0	OR219	3123	OHIO FRANKLIN REALTY LLC	R10 T06 S19 SD 27 E MCMANNIS	0.87
030-006-490-0	OR230	3269	OHIO FRANKLIN REALTY LLC	R10 T06 S19 SD 27 E MCMANNIS	0.9
030-006-510-0	OR219	3123	OHIO FRANKLIN REALTY LLC	R10 T06 S00 S 30-19 E& F WATSON ET AL	2.81
030-005-990-0	OR219	3123	OHIO FRANKLIN REALTY LLC	R10 T06 S19 SD 08 F WATSON	2.39
030-019-790-0	OR219	3123	OHIO FRANKLIN REALTY LLC	R10 T06 S19 SD 21	36.02
030-006-670-1	D.V 184	597	PARCELL JAMES W	R10 T06 S19 SD 45	0.567
030-006-670-0	D.V 184	597	PARCELL JAMES W	R10 T06 S19 SD 5-23	3.949
030-006-650-0	D.V 184	597	PARCELL JAMES W	R10 T06 S19 SD 36	1.49
030-006-670-2	OR118	257	RENTNER RICHARD C & SUZANNE L SL	R10 T06 S19 SD 49	1.082
030-004-110-0	OR229	2499	SCHAADS DAIRY FARM PROPERTIES LI	R10 T06 S19 SD 1	49.834

 Sections	— Hydro	 Parcels
Boundaries	— Lot	— Roads
Type	— Parcel	
— Hidden	— ROW	

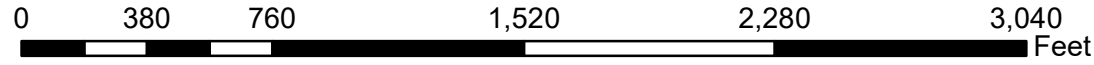

Source: Morgan County Engineer's Office
 Author: Marcia Wolfe
 Date: 3/18/2020

Disclaimer: The information that these maps contains is or reference purposes only. Please bring any erros to the attention of the Engineer's Office staff.
 Thank you

CENTER TOWNSHIP SECTION 19 R10- TWP 6 MORGAN COUNTY, OH

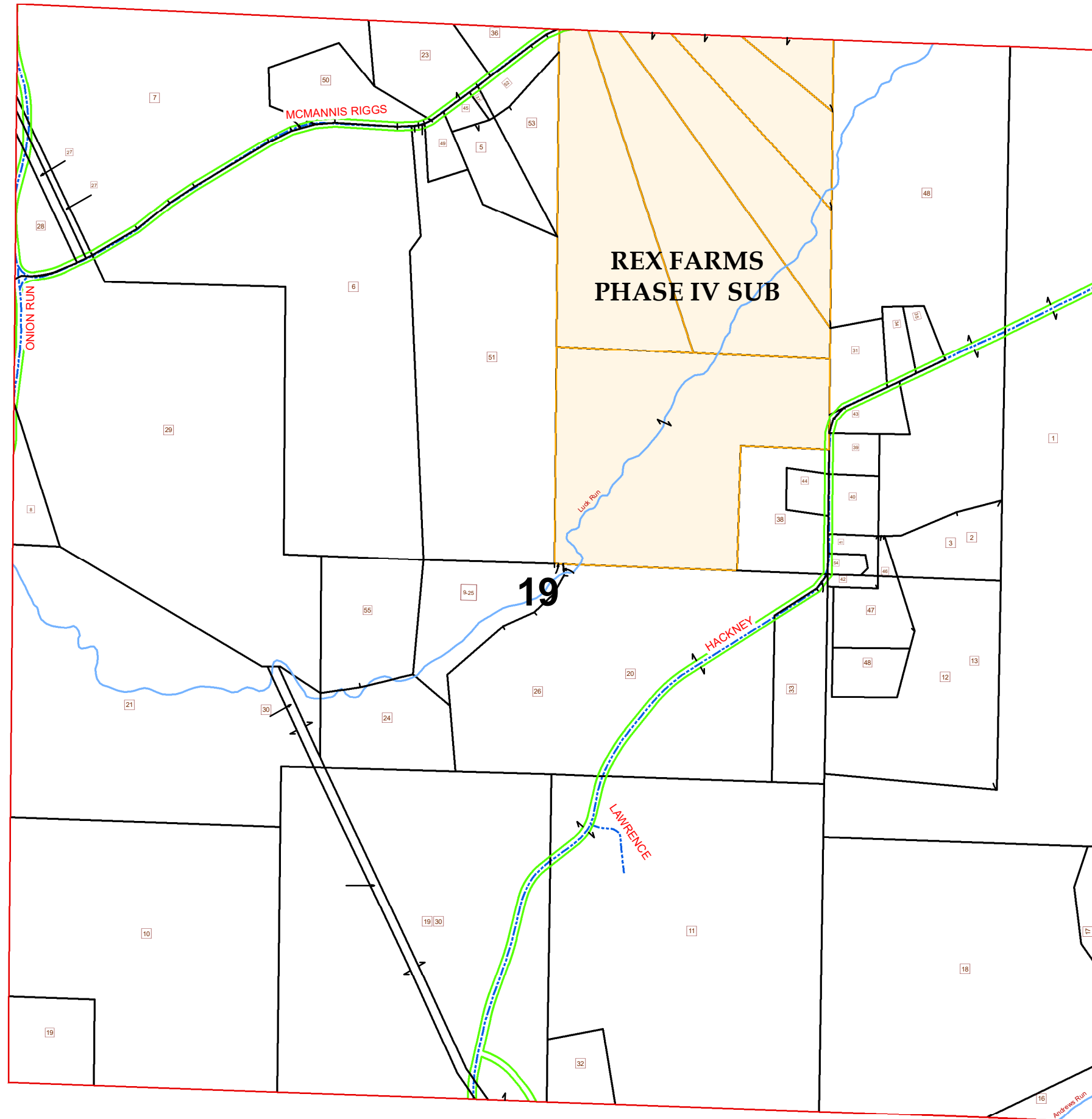

PIN	VOL	PAGE	Owner	LegalDescr	Acres
030-006-670-3	OR232	3120	SMITH MICHAEL A & BETH A	R10 T06 S19 SD 50 SURVIVORSHIP	4.445
030-006-690-0	OR192	753	SMITH MICHAEL A & BETH A	R10 T06 S19 SD 07 SURVIVORSHIP	28.619
030-003-470-0	OR207	105	STEPHENS GREGORY D & MICHELE R	R10 T06 S19 SD 35	1
030-008-290-0	OR32	1	STEPHENS GREGORY DON & MICHELE	R10 T06 S19 SD 12-13 SURVIVORSHIP	15.357
030-008-270-0	OR32	1	STEPHENS GREGORY DON & MICHELE	R10 T06 S19 SD 2 & 3 SURVIVORSHIP	3.584
030-006-660-0	OR226	817	TAYLOR GLENN R & HELEN P	R10 T06 S19 SD 37 SURVIVORSHIP	0.146
030-006-670-5	OR186	125	TAYLOR GLENN R & HELEN P	R10 T06 S19 SD 53 SURVIVORSHIP	3.286
030-006-660-1	OR226	817	TAYLOR GLENN R & HELEN P	R10 T06 S19 SD 52 SURVIVORSHIP	1.592

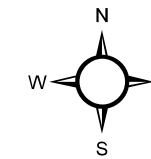

Boundaries		Type	
	Sections		Hydro
	Lot		Roads
	Parcel		ROW
	Hidden		

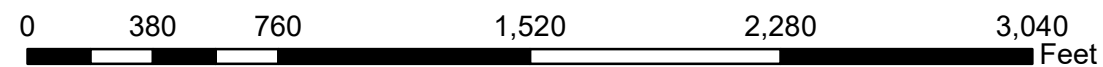

Disclaimer: The information that these maps contains is or reference purposes only. Please bring any erros to the attention of the Engineer's Office staff.
Thank you